

**Lower Thames Crossing
2.2 Land Plans
Volume C
(Sheets 21 to 49 of 49)**

APFP Regulation 5(2)(i)

Infrastructure Planning (Applications:
Prescribed Forms and Procedure)
Regulations 2009

Volume 2

DATE: October 2022

Planning Inspectorate Scheme Ref: TR010032
Application Document Ref: TR010032/APP/2.2

VERSION: 1.0

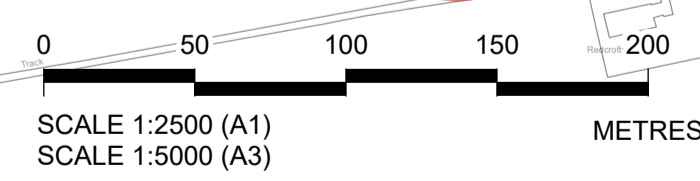
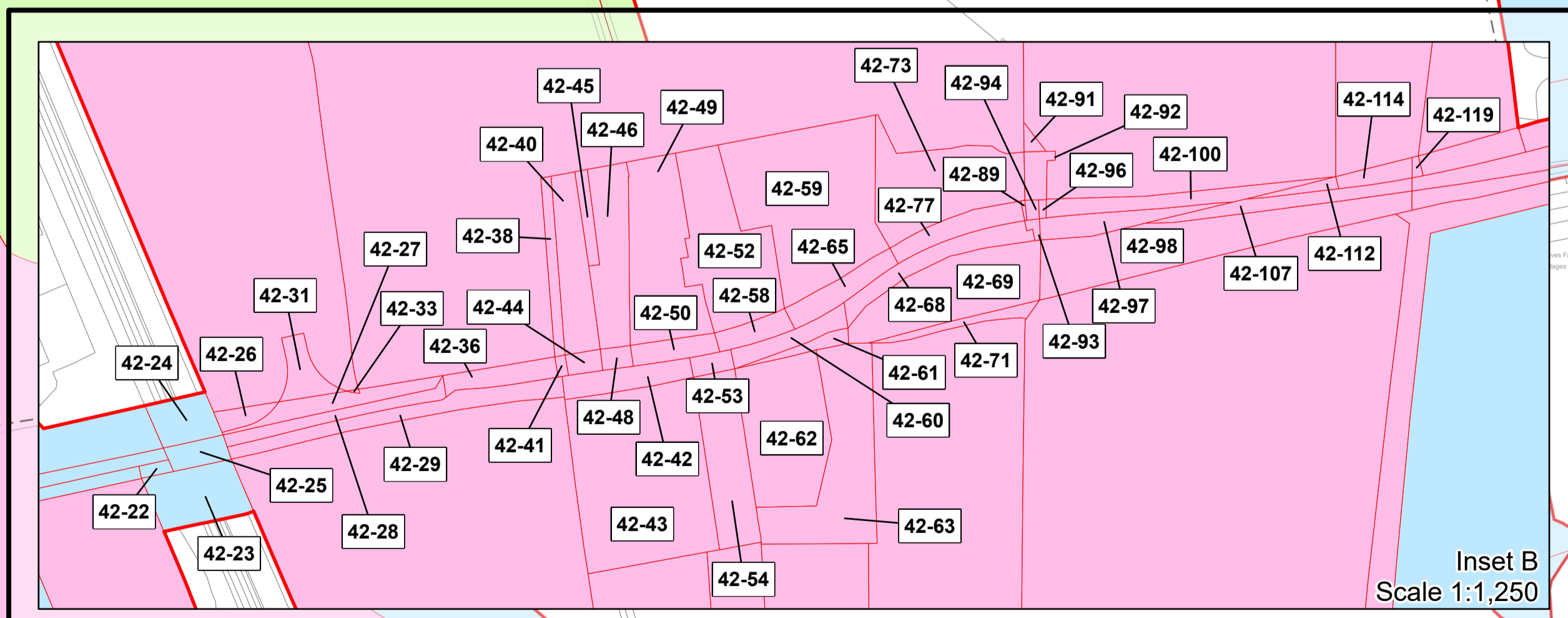
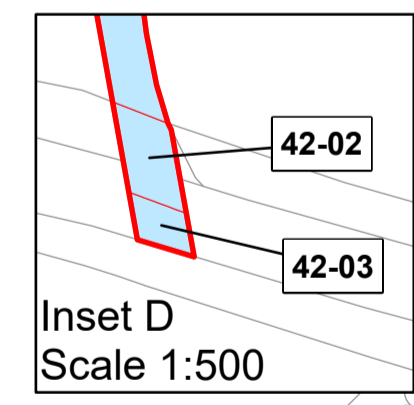
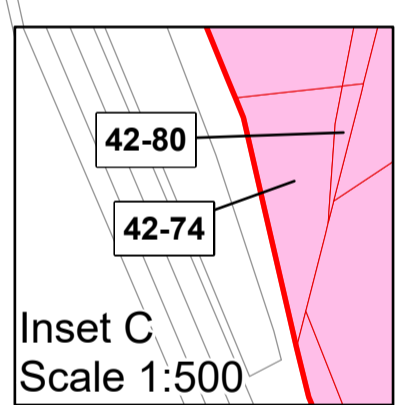
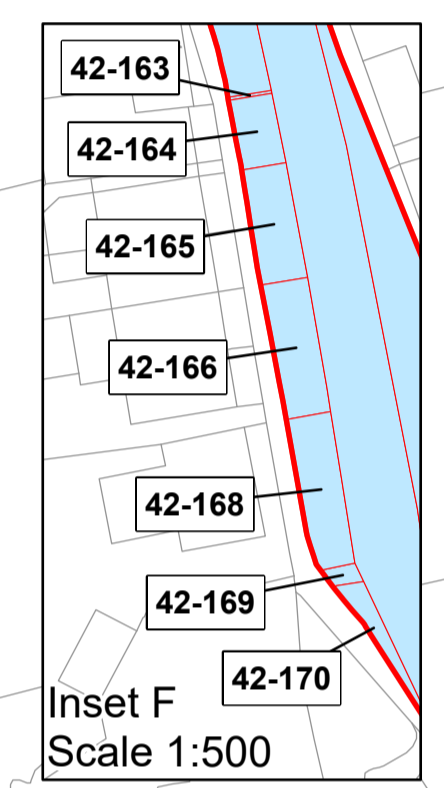
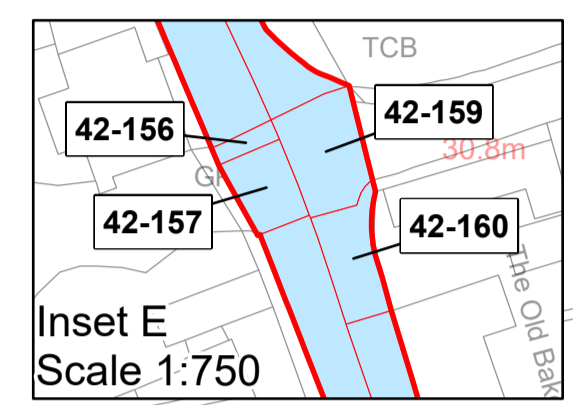
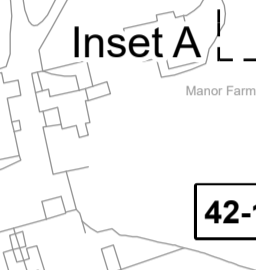
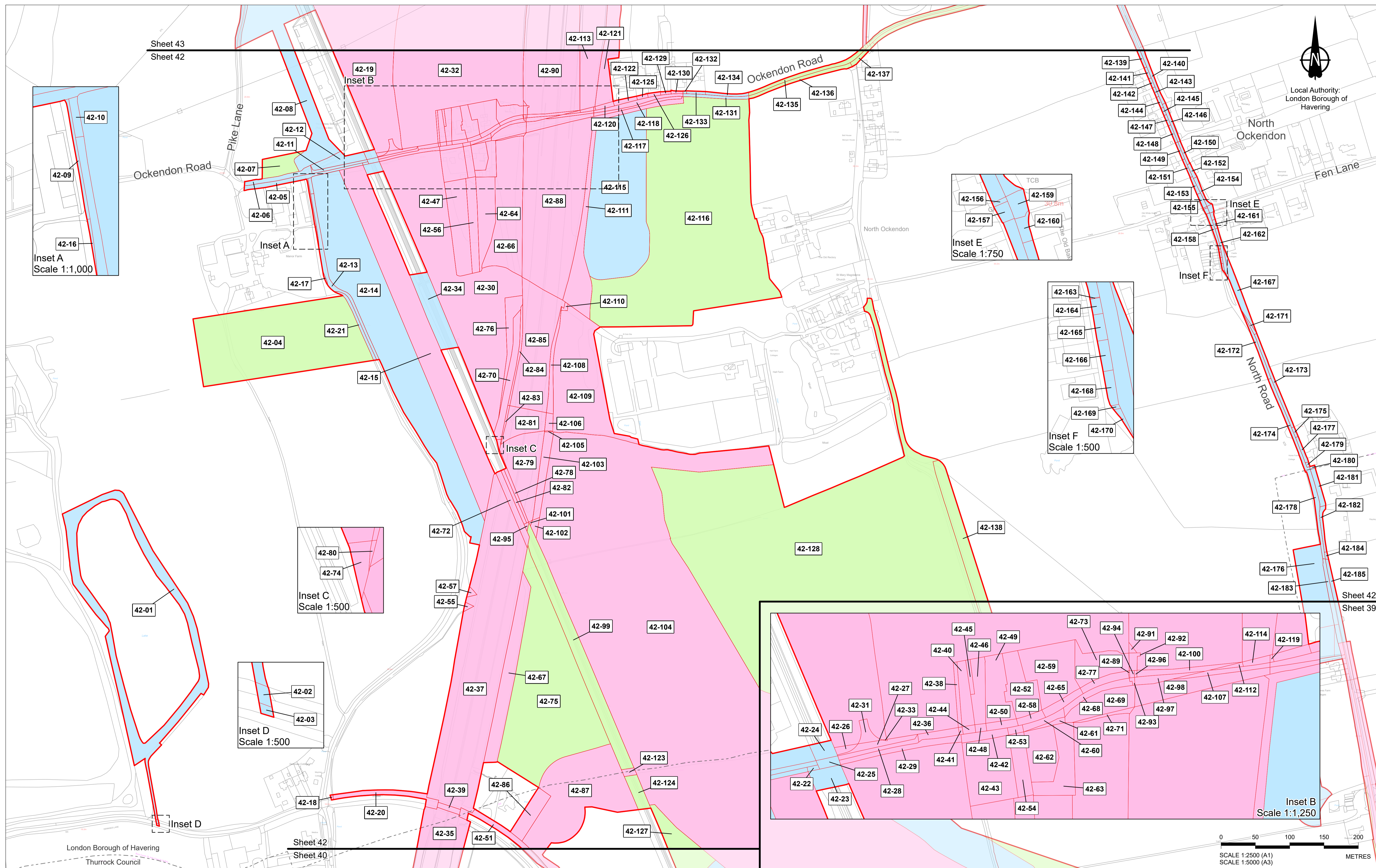

P01	S1	17/10/2022	Issued for Information	LS	AA	TG
Rev	Status	Rev. Date	Purpose of revision	Drawn	Chkd	Apprvd

1. All dimensions are in metres unless stated otherwise.
 2. These Land Plans should be read in conjunction with other plans and documents in the Development Consent Order application (TR020032/APP/3.1), in particular the Book of Reference (TR020032/APP/4.2).
 3. All easements, servitudes and private rights in land are proposed to be extinguished on land shown coloured pink on these land plans, unless stated otherwise in the Book of Reference.
 4. All easements, servitudes and private rights of the subsoil are proposed to be extinguished on land shown coloured yellow and orange on these land plans, unless stated otherwise in the Book of Reference.
 5. All easements, servitudes and private rights in land are proposed to be extinguished, so far as their continued exercise would be inconsistent with the exercise of the rights or restrictions proposed to be acquired by the undertaker on land shown coloured blue, yellow and orange on these land plans, unless stated otherwise in the Book of Reference.
 6. All easements, servitudes and private rights are proposed to be suspended while the undertaker is in temporary possession of the land shown coloured green, blue and orange on these land plans, unless stated otherwise in the Book of Reference.
 7. The number labels relate to plot numbers. Please refer to the Book of Reference for more information about these plots, including the approximate area of each plot. In this numbering convention, a plot number comprises the sheet number followed by the actual plot number, e.g. Plot 01-24, where '01' is the sheet number.

- Legend**
- Order Limits
 - Permanent Acquisition of Land
 - Permanent Acquisition of Subsoil and Rights
 - Permanent Acquisition of Subsoil and Rights and Temporary Possession of Land at Surface
 - Temporary Possession of Land
 - Temporary Possession of Land and Permanent Acquisition of Rights
 - Local Authority Boundary

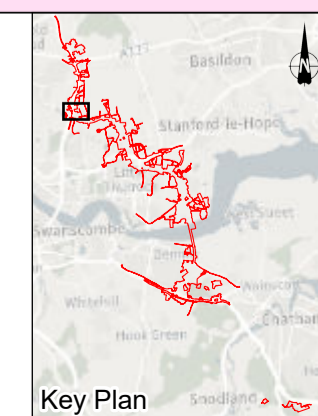

Client: **national highways**

Project: **LOWER THAMES CROSSING**

Status	DCO Application	Original Size	A1	Revision	P01
Application Document Number	TR010032/APP/2.2	Scale	1:2,500		
Drawing Title	LAND PLANS REGULATION 5(2)(i) SHEET 42				
Drawing Number	HE450039-CJV-BOP-ZZZ_BD000000_-DR-BL-20042				

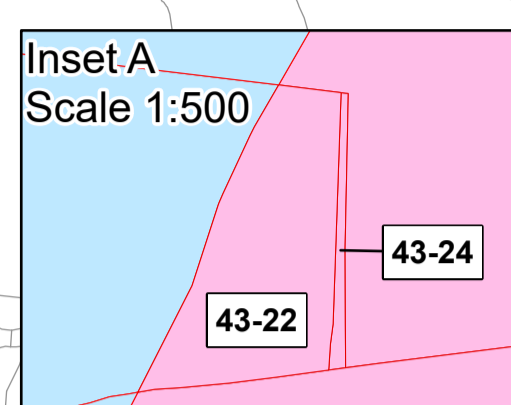
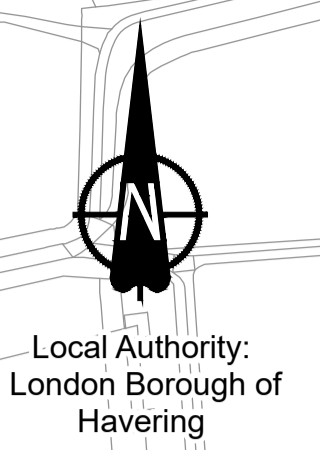
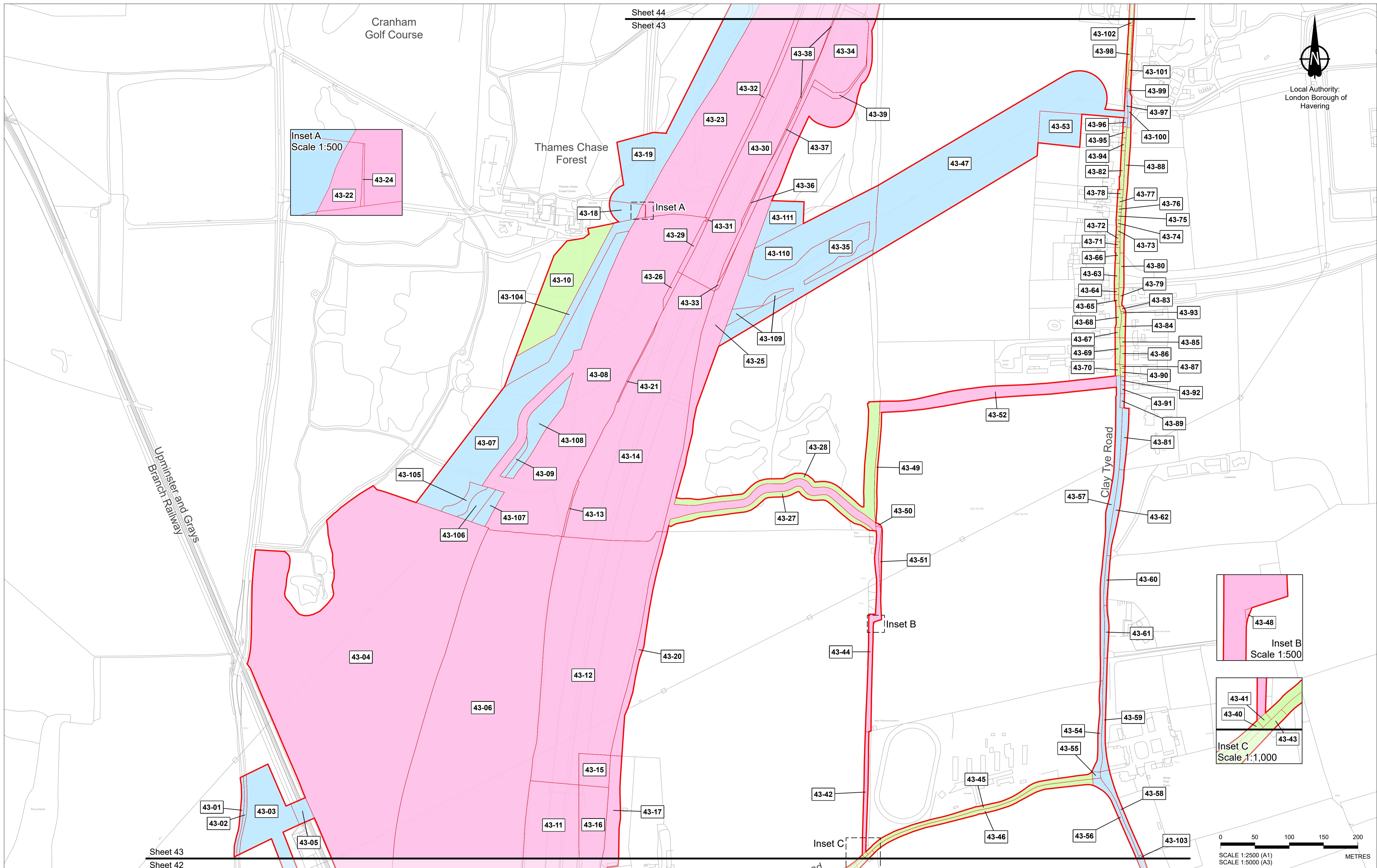

Inset A

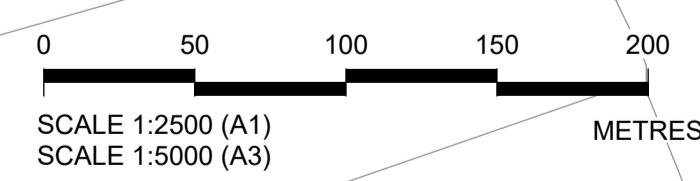
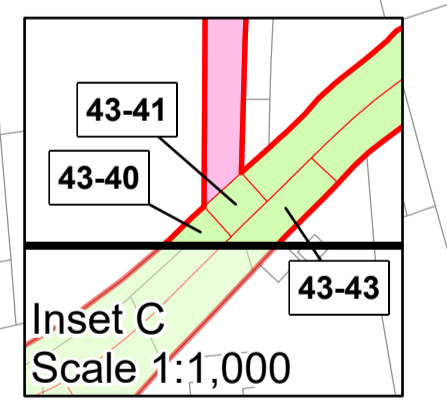
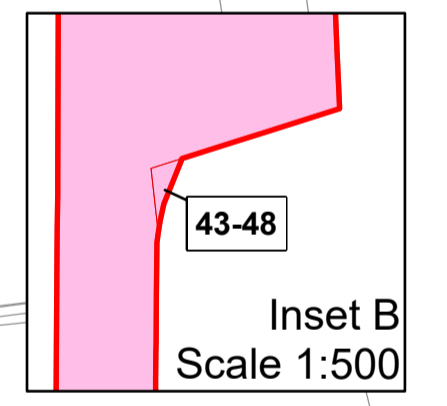

Sheet 43
Sheet 42

- Legend**
- Order Limits
 - Permanent Acquisition of Land
 - Permanent Acquisition of Subsoil and Rights
 - Permanent Acquisition of Subsoil and Rights and Temporary Possession of Land at Surface
 - Temporary Possession of Land
 - Temporary Possession of Land and Permanent Acquisition of Rights

1. All dimensions are in metres unless stated otherwise.
 2. These Land Plans should be read in conjunction with other plans and documents in the Development Consent Order application (TR020032/APP/3.1), in particular the Book of Reference (TR020032/APP/4.2).
 3. All easements, servitudes and private rights in land are proposed to be extinguished on land shown coloured pink on these land plans, unless stated otherwise in the Book of Reference.
 4. All easements, servitudes and private rights of the subsoil are proposed to be extinguished on land shown coloured yellow and orange on these land plans, unless stated otherwise in the Book of Reference.
 5. All easements, servitudes and private rights in land are proposed to be extinguished, so far as their continued exercise would be inconsistent with the exercise of the rights or restrictions proposed to be acquired by the undertaker on land shown coloured blue, yellow and orange on these land plans, unless stated otherwise in the Book of Reference.
 6. All easements, servitudes and private rights are proposed to be suspended while the undertaker is in temporary possession of the land shown coloured green, blue and orange on these land plans, unless stated otherwise in the Book of Reference.
 7. The number labels relate to plot numbers. Please refer to the Book of Reference for more information about these plots, including the approximate area of each plot. In this numbering convention, a plot number comprises the sheet number followed by the actual plot number, e.g. Plot 01-24, where '01' is the sheet number.

Rev	Status	Rev. Date	Purpose of revision	Drawn	Chck'd	Apprv'd
P01	S1	03/10/2022	Issued for Information	LS	AA	TG

Client

Project

LOWER THAMES CROSSING

Key Plan

Status: **DCO Application**

Application Document Number: **TR010032/APP/2.2**

Drawing Title: **LAND PLANS REGULATION 5(2)(i) SHEET 43**

Drawing Number: **HE450039-CJV-BOP-ZZZ_BD000000_-DR-BL-20043**

Original Size: **A1**

Revision: **P01**

Scale: **1:2,500**